

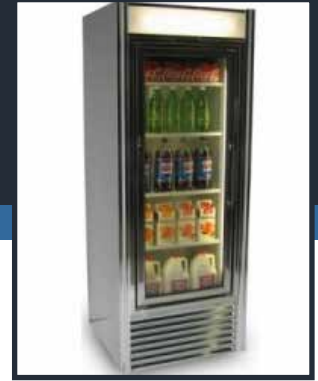

Manufacturer and Supplier of
Restaurant Equipment
 and **Display Cases**
 for the Food Service Industry



MODEL: ADM-1-SC

PRODUCT FEATURES

- Self-Contained
- White vinyl coated aluminum interior
- (1) glass swinging door
- Reversible Anthony Door
- Florescent Integrated door light
- Holds 33°-41°F temperatures
- Adjustable vinyl coated wire shelves
- Compressor can be serviced easily
- Environmentally friendly 134A refrigerant
- 1/3 HP, 115V, 9.2 Amps

- | | |
|-------------------|-------------------------|
| Casters | 5" Casters Optional |
| Warranty | 1 yr Parts & Compressor |
| Front Door | Glass |
| Front Motor Cover | Anodized Aluminum |
| Interior Walls | White Aluminum |
| Outside Back | Galvanized |

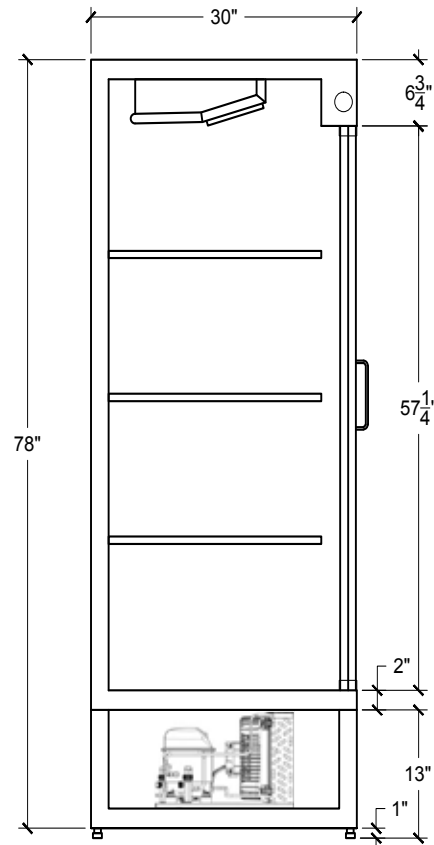

Product Specifications

Dimensions	Doors	Shelves	Cooling Cycle	Refrigerant	HP	Power	Ampr.	BTU	Freon (oz)
30"x 30"x 78"	1	3	33-41	134a	1/3	115/60/1	12.5	1100	11.5

Additional Models

Model	Doors	Shelves	Cooling Cycle	Refrigerant	HP	Power	Ampr.	BTU	Freon (oz)
ADM-2-SC	2	6	33-41	134a	1/2	115/60/1	14	1850	15
ADM-3-SC	3	9	33-41	134a	3/4	115/60/1	18.5	3000	21

* Model number designates number of doors. Due to product improvement, we reserve the right to change specifications without notice.