

Model:
BCI-60-SC

Bakery Display Case

 Cooler

 Stainless

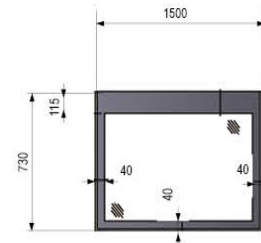
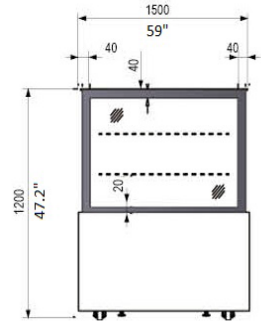
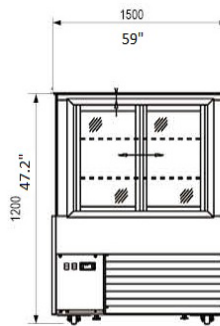

5-15P



Doors	Shelves	Refrigerant	HP	Power	Amps.	Cu.ft.	Weight(lbs.)
2	4	R290	1/2+	115/60/1	16	18	300

FEATURES

- ☒ **Stainless steel exterior** retains attractive finish longer.
- ☒ **Rounded corner** design inside of the cabinet makes it easy to clean it.
- ☒ **Standard door features:**
 - ✓ Positive seal self-closing sliding glass doors.
- ☒ **Refrigeration system:**
 - ✓ Holds 33°F to 41°F (0.5°C to 5°C) for the best in food preservation.
- ☒ **Electronic control system:**
 - ✓ Adjustable temperature set point and defrost frequency.
 - ✓ Error codes to diagnose service issues.
- ☒ **Shelves:** Adjustable, heavy duty glass shelves.
- ☒ **Standard heavy-duty casters** make it easy to move and clean underneath.
- ☒ "No Stoop" lower shelf.
- ☒ Easily accessible condenser coil for cleaning, and easy service access.
- ☒ Simple installation with no plumbing required.