

BLACK DIAMOND

G A S E Q U I P M E N T

BDCTC Series Specifications

Heavy Duty Radiant Gas Countertop Charbroilers

Black Diamond's Heavy Duty Radiant Gas Countertop Charbroilers are designed for use with either natural or LP gas. Constructed of stainless steel front and sides that are fully welded, these units are able to stand the toughest of kitchen environments. Each unit includes tips for field conversion to LPG.



This item meets the sanitation standards imposed by the ETL, a division of the Intertek Group.



This item meets the electrical product safety standards imposed by the ETL, a division of the Intertek Group, for use in the United States and Canada.



BDCTC-24
BDCTC-36
BDCTC-48

Plan Views

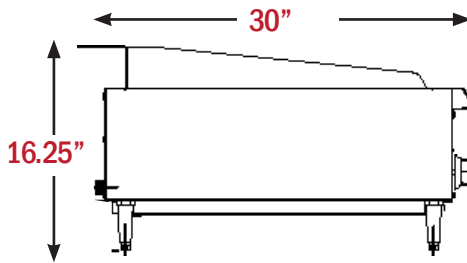

SIDE VIEW

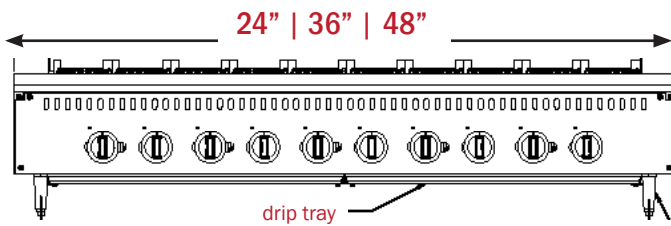

FRONT VIEW

Features

- Stainless steel front bullnose design and side construction that's fully welded for extra durability
- 20,000 BTU per burner
- One cast iron burner every 6" grate width
- Cast iron grill grates are reversible and height adjustable
- 4"-5" adjustable legs
- Separate gas valves for each burner with standing pilot ignition system
- Removable stainless steel drip tray for easy cleaning
- 3/4" rear NPT gas inlet
- ETL Listed and ETL Sanitation

Drip Tray Dimensions

Model	Width	Depth	Height
BDCTC-24	21.25	24.5	0.75
BDCTC-36	32	24.5	0.75
BDCTC-48	21.25	24.5	0.75

Specifications

Model Number	BDCTC-24/NG	BDCTC-36/NG	BDCTC-48/NG
Total BTU	80,000 BTU	120,000 BTU	160,000 BTU
Overall Dimensions (in)	16.25"H x 24"W x 30"D	16.25"H x 36"W x 30"D	16.25"H x 48"W x 30"D
Burners	4	6	8
Net Weight (lbs)	209 lbs	302 lbs	388 lbs
Gross Weight (lbs)	243 lbs	335 lbs	421 lbs
Drip Tray	1	1	2

Black Diamond warrants this product to be free of defects in materials and workmanship for period of 1 year from the date of original installation.