

MAXX COLD

Maxx Cold | The Legacy Companies
 3355 Enterprise Avenue, Suite 160, Fort Lauderdale, FL 33331
 (954) 202-7419 • Fax (954) 202-7337 • (877) 600-8401
 www.MaxximumFoodService.com • Info@MaxxColdFoodService.com

Project Name: _____
 Location: _____
 Item #: _____ Qty: _____
 Model: _____

BACK BAR COOLERS

**LIMITED STOCK
 CALL FOR DETAILS**

Model: MCBB24-1B MCBB60-2B MCBB70-2B MCBB90-3B

International Model:
 Add -50 (220V/50Hz/1Ph)



MCBB24-1B



MCBB60-2B



MCBB70-2B



MCBB90-3B

Maxx Cold Back Bar Coolers with stainless steel top are designed to keep cold beverages at the optimum temperature for serving customers. The entire cabinet is foamed in place with low ODP polyurethane insulation. The galvanized steel interior with stainless steel floors and a wall thickness of 1.5” guarantees years of cold refrigeration. These self-contained, slide out units use R-134A refrigerant and come equipped with coated evaporator coils and a condensate evaporator.

FEATURES

- Easy to grip recessed door handles
- Adjustable heavy duty wire shelves (2 per section/door)
- Four (4) 5” casters included on MCBB-1B model
- Locking doors
- Available in 115V/60Hz, 220V/60Hz & 230V/60Hz

TEMPERATURE

- Holding temperature: 33° to 41°F (1° to 5°C)
- Utilizes environmentally friendly refrigerant R134A

CONSTRUCTION

- Painted black coated steel exterior
- Galvanized steel interior
- Stainless steel interior floor
- Stainless steel top
- CFC-free Polyurethane insulated walls and doors
- Slide out condensing unit for easy cleaning and servicing
- Epoxy coated evaporator coils to resist corrosion

REFRIGERANT

Environmentally friendly and CFC-free R134A

ELECTRIC

115/60Hz/1 Ph (NEMA 5-15)

Cord set includes plug & 9.8’ (3m) cord

220V/60Hz & 230V/60Hz available as options

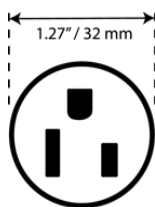

NEMA 5-15P



Certified to
 ANSI-NSF 7



Certified to
 ANSI UL 471

Maxx Cold WARRANTY (USA / CANADA)

Three (3) years parts and on-site labor

Five additional (5) years compressor (part only)

Administered by The Legacy Companies, 877.368.2797

24/7 tech support provided

Due to periodic changes in designs, methods, procedures, policies and regulations, the specifications contained in this sheet are subject to change without notice. While we exercise good faith efforts to provide information that is accurate, we are not responsible for errors or omissions in information provided or conclusions reached as a result of using the specifications. By using the information provided, the user assumes all risks in connection with such use.

The built in performance enhancing functions ensure that given proper attention and preventative maintenance, each Maxx Product will deliver years of trouble free, reliable, low maintenance, efficient operation.

BACK BAR COOLERS

MCBB24-1B

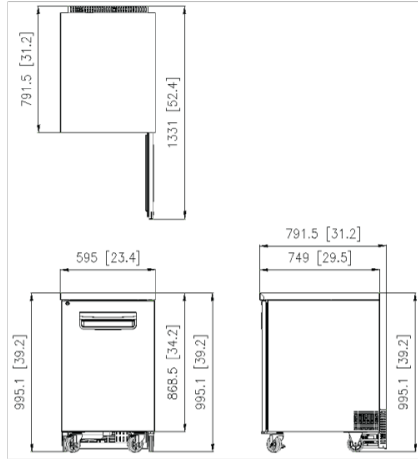

MCBB60-2B

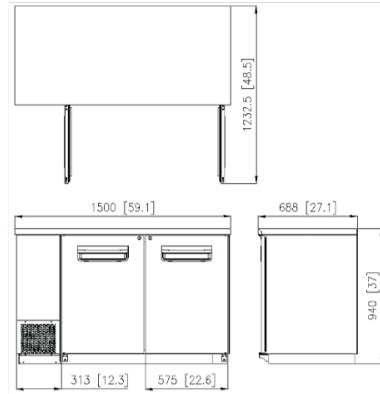

MCBB70-2B

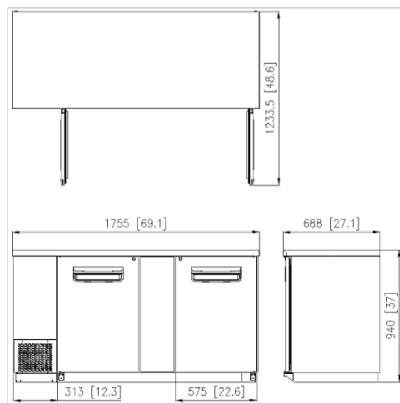

MCBB90-3B

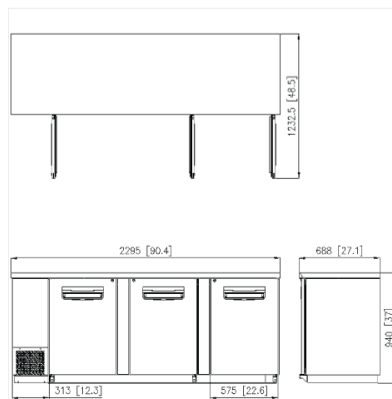

	Dimensions* in / mm	Capacity	Temperature Range	Voltage	Amps	Unit Weight	HP
MCBB24-1B	23.4 x 31.2 x 39.2 595 x 792 x 995	7 Cu Ft 198 L	33° - 41°F 1° - 5° C	115V/60Hz/1	3.3	187 lb 85 kg	1/5
MCBB60-2B	59.1 x 27.1 x 37 1500 x 688 x 940	19 Cu Ft 538 L	33° - 41°F 1° - 5° C	115V/60Hz/1	6.3	276 lb 125 kg	3/8
MCBB70-2B	69.1 x 27.1 x 37 1755 x 688 x 940	23 Cu Ft 651 L	33° - 41°F 1° - 5° C	115V/60Hz/1	6.3	298 lb 135 kg	3/8
MCBB90-3B	90.4 x 27.1 x 37 2295 x 688 x 940	31.5 Cu Ft 892 L	33° - 41°F 1° - 5° C	115V/60Hz/1	6.3	441 lb 200 kg	3/8

Due to periodic changes in designs, methods, procedures, policies and regulations, the specifications contained in this sheet are subject to change without notice. While we exercise good faith efforts to provide information that is accurate, we are not responsible for errors or omissions in information provided or conclusions reached as a result of using the specifications. By using the information provided, the user assumes all risks in connection with such use.