

# MAXX COLD

Maxx Cold | The Legacy Companies  
 3355 Enterprise Avenue, Suite 160, Fort Lauderdale, FL 33331  
 (954) 202-7419 • Fax (954) 202-7337 • (877) 600-8401  
 www.MaxximumFoodService.com • Info@MaxxColdFoodService.com

Project Name: \_\_\_\_\_

Location: \_\_\_\_\_

Item #: \_\_\_\_\_ Qty: \_\_\_\_\_

Model: \_\_\_\_\_

**LIMITED STOCK  
 CALL FOR DETAILS**

## GLASS DOOR BACK BAR COOLERS

Model:  MCBB24-1BG  MCBB60-2BG  MCBB70-2BG  MCBB90-3BG

International Model:  
 Add -50 (220V/50Hz/1Ph)



MCBB24-1BG



MCBB60-2BG



MCBB70-2BG



MCBB90-3BG

Maxx Cold Glass Door Back Bar Coolers with stainless steel top are designed to keep cold beverages at the optimum temperature for serving customers. The entire cabinet is foamed in place with low ODP polyurethane insulation. The galvanized steel interior with stainless steel floors and a wall thickness of 1.5” guarantees years of cold refrigeration. These self-contained, slide out units use R-134A refrigerant and come equipped with coated evaporator coils and a condensate evaporator.

### FEATURES

- Easy to grip recessed door handles
- Adjustable heavy duty wire shelves (2 per section/door)
- Four (4) 5” casters included on MCBB-1BG model
- Available in 115V/60Hz, 220V/60Hz & 230V/60Hz

### TEMPERATURE

- Holding temperature: 33° to 41°F (1° to 5°C)
- Utilizes environmentally friendly refrigerant R134A

### CONSTRUCTION

- Painted black coated steel exterior
- Galvanized steel interior
- Stainless steel interior floor
- Stainless steel top
- Glass door
- CFC-free Polyurethane insulated walls and doors
- Slide out condensing unit for easy cleaning and servicing
- Epoxy coated evaporator coils to resist corrosion

### REFRIGERANT

Environmentally friendly and CFC-free R134A

### ELECTRIC

115/60Hz/1 Ph (NEMA 5-15)

Cord set includes plug & 9.8’ (3m) cord

220V/60Hz & 230V/60Hz available as options

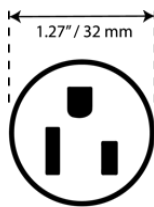

NEMA 5-15P



Certified to  
 ANSI-NSF 7



Certified to  
 ANSI UL 471

### Maxx Cold WARRANTY (USA / CANADA)

Three (3) years parts and on-site labor

Five additional (5) years compressor (part only)

Administered by The Legacy Companies, 877.368.2797

24/7 tech support provided

Due to periodic changes in designs, methods, procedures, policies and regulations, the specifications contained in this sheet are subject to change without notice. While we exercise good faith efforts to provide information that is accurate, we are not responsible for errors or omissions in information provided or conclusions reached as a result of using the specifications. By using the information provided, the user assumes all risks in connection with such use.

The built in performance enhancing functions ensure that given proper attention and preventative maintenance, each Maxx Product will deliver years of trouble free, reliable, low maintenance, efficient operation.

# GLASS DOOR BACK BAR COOLERS

MCBB24-1BG

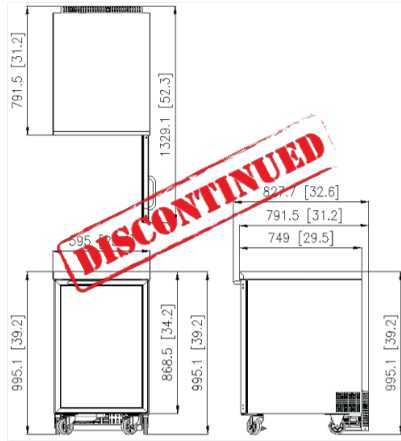

MCBB60-2BG

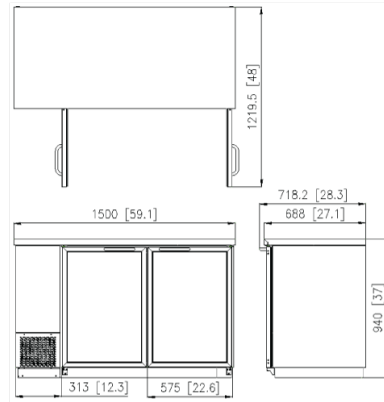

MCBB70-2BG

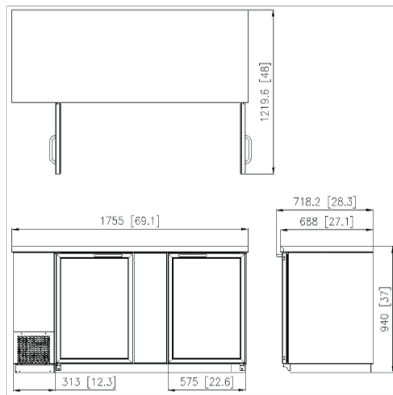

MCBB90-3BG

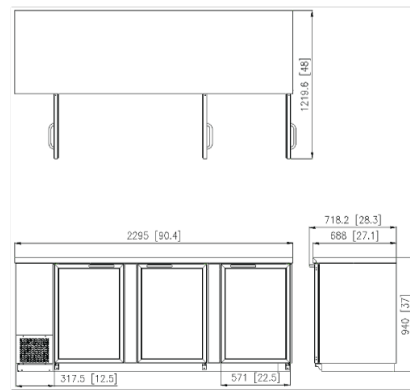

	Dimensions* in / mm	Capacity	Temperature Range	Voltage	Amps	Unit Weight	HP
<b>MCBB24-1BG (Discontinued)</b>	23.4 x 31.2 x 39.2 595 x 792 x 995	7 Cu Ft 198 L	33° - 41°F 1° - 5° C	115V/60Hz/1	1.6	198 lb 90 kg	1/5
<b>MCBB60-2BG</b>	59.1 x 27.1 x 37 1500 x 688 x 940	19 Cu Ft 538 L	33° - 41°F 1° - 5° C	115V/60Hz/1	3.1	298 lb 135 kg	3/8
<b>MCBB70-2BG</b>	69.1 x 27.1 x 37 1755 x 688 x 940	23 Cu Ft 651 L	33° - 41°F 1° - 5° C	115V/60Hz/1	3.1	320 lb 145 kg	3/8
<b>MCBB90-3BG</b>	90.4 x 27.1 x 37 2295 x 688 x 940	31.5 Cu Ft 892 L	33° - 41°F 1° - 5° C	115V/60Hz/1	3.1	474 lb 215 kg	3/8

Due to periodic changes in designs, methods, procedures, policies and regulations, the specifications contained in this sheet are subject to change without notice. While we exercise good faith efforts to provide information that is accurate, we are not responsible for errors or omissions in information provided or conclusions reached as a result of using the specifications. By using the information provided, the user assumes all risks in connection with such use.